



Prudential Georgia Realty

BrentHoffman.com

"When You Want It Sold"

Commercial Real Estate Services

FORMER Dave's Goody Barn

**2080 Memorial Dr.
Gainesville, GA 30504**

**FOR LEASE
Great rate @\$3.25 s.f.**

RENOVATED IN 2009
**30,280 s.f. of warehouse/
retail/industrial space**



- ◆ 17.8' ceiling
- ◆ 1,200 s.f. offices
- ◆ Large outside storage
- ◆ New parking area
- ◆ Two loading docks
- ◆ Drive-in door
- ◆ High 3-phase power
- ◆ Located on high-traffic Memorial Dr., just off Brown Bridge Rd.



Presented by: Brent Hoffman
Prudential Georgia Realty
351 Jesse Jewel Parkway
Gainesville, GA 30501
770-533-6721 (direct)
770-536-3007 (office)
Brent@BrentHoffman.com



More info and video at www.BrentHoffman.com
Prudential Georgia Realty 770-533-6721



30,270 s.f. of Warehouse/Industrial space at a great rate! Located on high-traffic Memorial Drive, just off Browns Bridge Road. Building was used as retail space when occupied by Dave's Goody Barn. 17.8' ceilings, 1,200 s.f. offices, large multi-stall rest-rooms, large outside storage, two loading docks, drive-in door, 3-phase high-high power, and new parking area.



2080 Memorial Drive FLOOR PLAN (not to scale)

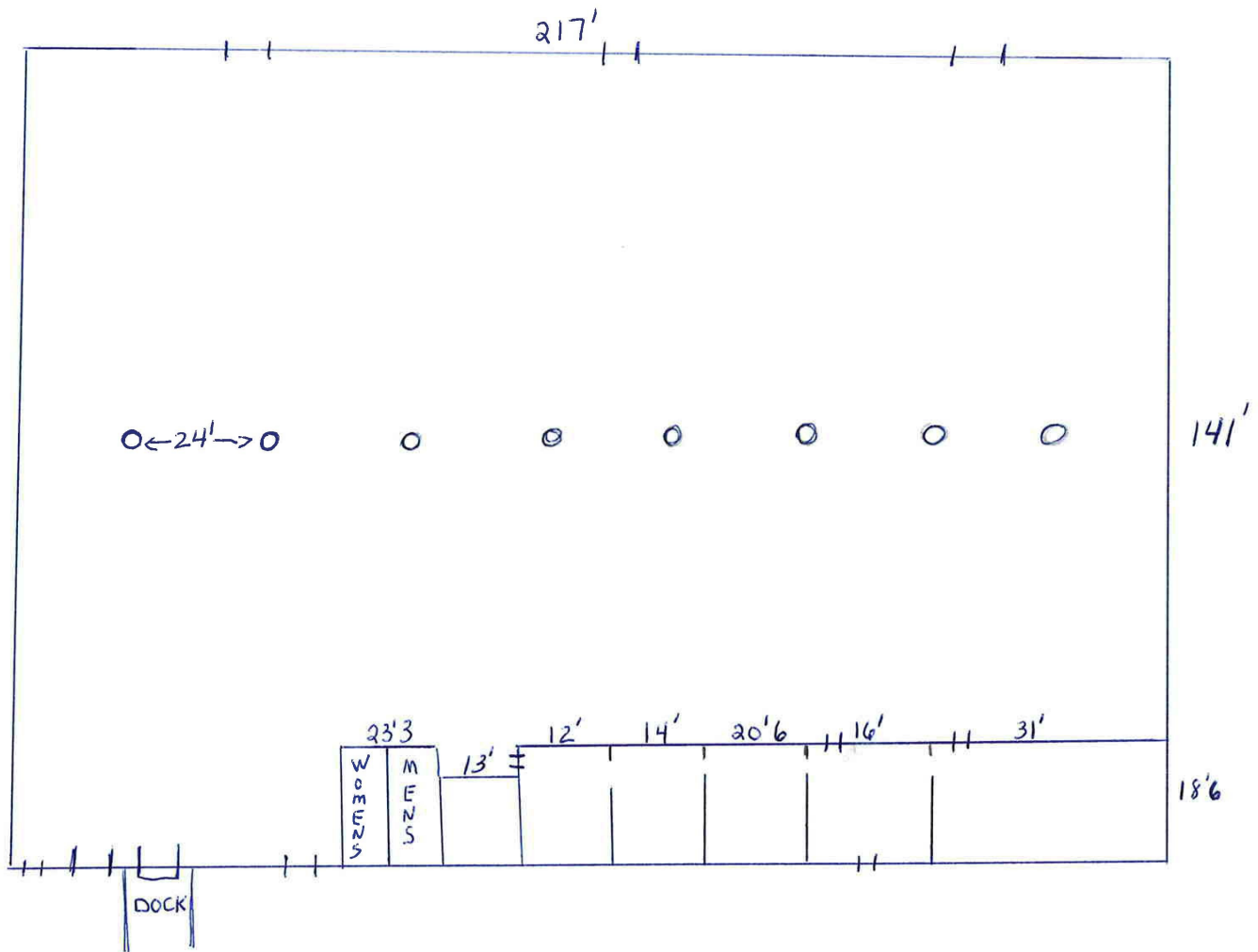

2080 MEMORIAL DRIVE

